



BADGER
B A S K E T



REVERSIBLE DOUBLE DOLL PRAM - PINK POLKA DOT

Assembly and Use Instructions. Adult assembly Required.

Read all instructions before use.

**This manual is part of the product and
must be saved for future reference.**



*Dolls & accessories
not included.*

MODEL NUMBER*:
99650

VERSION CODE*:
2.0/0813/HF

** Model and Version numbers are needed
if replacement parts are requested*



**If you need product
parts, see Page 2!**

FOR REPLACEMENT PARTS:

Go to our web site: <http://www.badgerbasket.com/parts>
Or scan QR code at right with your smartphone



2.0/0813/HF



BEFORE YOU BEGIN ASSEMBLY:

Check all parts. If anything is missing or not satisfactory, please DO NOT call the store or return the product to them. Please go online to:

<http://www.badgerbasket.com/parts>

Most problems are resolved without you needing to leave home.

When contacting us, please have this instruction manual, your product model number, and your Version Code ready.

Your Model Number is: 99650

Your Version Code is: 2.0/0813/HF



WARNING

ADULT ASSEMBLY REQUIRED
DUE TO THE PRESENCE OF SMALL PARTS AND SHARP
POINTS DURING ASSEMBLY, KEEP OUT OF REACH OF
CHILDREN UNTIL ASSEMBLY IS COMPLETE.



WARNING - CAUTION

READ ALL INSTRUCTIONS before use of this product. Use only the parts and hardware provided by Badger Basket. Keep instructions for future use. Do not use the product if it is damaged or broken. Periodically inspect the product to ensure all parts remain tight. **This item is a toy for dolls only. It is never to be used for real infants or pets. No product is a substitute for adult supervision. Always supervise your child during play.** For children ages three (3) years and older. Stroller should be folded and unfolded by an adult only. Never use the doll stroller unless the frame locks are properly secured. Folded stroller should be stored out of reach of children.

Never sit on or stand on the toy.

PARTS & QUANTITY INCLUDED:

A x 1 - STROLLER FRAME

B x 1 - LONG REAR AXLE

C x 2 - LARGE WHEEL

D x 4 - AXLE RETAINER CLIP

E x 6 - HUB CAP

F x 2 - SHORT FRONT AXLE

G x 4 - SMALL WHEEL

H x 2 - SEAT

STEPS FOR ASSEMBLY:

(1)

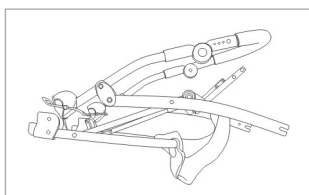

(2)

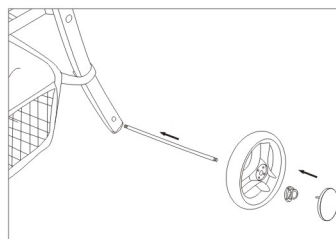

1. Unfold the (A) Stroller Frame.

2. Insert the (B) Long Rear Axle through the rear posts on the (A) Stroller Frame. Put one (C) Large Wheel onto each end of the Axle. Snap one (D) Axle Retainer Clip onto each end of the axle, and snap one (E) Hub Cap onto each wheel.

(3)

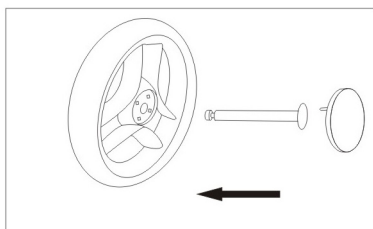

(4)

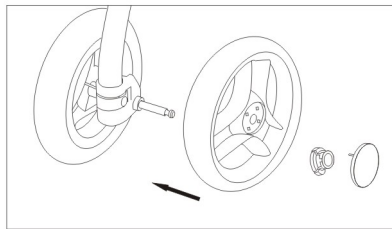

3. Insert one (F) Short Front Axle through one (G) Small Wheel. Snap on one (E) Hub Cap.

4. Insert this wheel assembly through one of the front frame posts on the (A) Stroller Frame. Slide a second (G) Small Wheel onto the (F) Short Front Axle, and secure with one (D) Axle Retainer Clip and one (E) Hub Cap.

~ Repeat Steps 3 & 4 to assemble/attach the 3rd and 4th front wheels to the stroller frame. ~

(5)

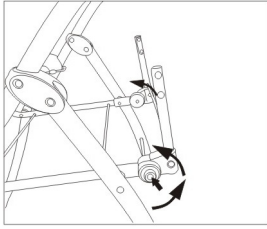

(6)

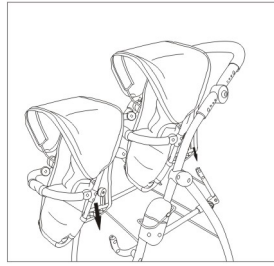

5. Adjust the backseat on the stroller frame by pressing the two buttons on the sides of the seat bottom frame.

6. Slide the two (H) Seats onto the seat tracks as shown. You can insert them facing forward or back, and they can be removed and reversed **BY AN ADULT** at any time if you want the dolls to face the opposite way.

(7)

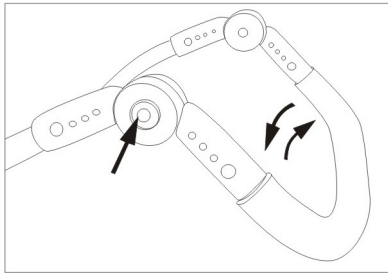

(8)

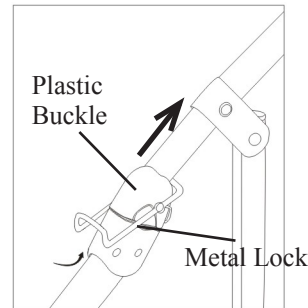

7. Adjust handle height/position by pressing the handle buttons and moving the handle up and down.

8. The stroller is assembled!

To fold the stroller (only to be done by an adult), lift up the metal safety frame locks as you also pull up on the plastic frame buckles to release the hinge and collapse the stroller into the folded position.

Seat Canopies can be opened or folded flat. Seat recline can be adjusted on both seats by holding the seat back and pulling forward or pushing back (do not force beyond the limits of the ratcheting mechanism).

CARE INSTRUCTIONS:

Hand wash removable fabric pieces (seats, basket) in cold water with mild detergent and air dry. Canopies can be spot cleaned with cold water and mild detergent and air dry.
Wipe the metal/plastic frame clean as needed with a damp cloth and dry thoroughly.

